

**PHASE A**  
**PHASE A NOTES**

- ESTABLISH THE ENTRANCE EXIT AND HAUL ROAD INTO THE SITE AT ROAD 96 ACCORDING TO THE APPROPRIATE MUNICIPAL STANDARDS.
- PRIOR TO ANY ON SITE OPERATIONS, CONSTRUCT OR UPGRADE THE FENCING ON THE LICENCED BOUNDARIES TO THE STANDARDS OF THE AGGREGATE RESOURCES ACT (1.2m HIGH WIRE FENCE), EXCEPT WHERE SITE PLAN VARIANCES ARE NOTED AND INSTALL MARKER POSTS. ALL FENCING SHALL BE MAINTAINED.
- STRIP WOODLAND SOILS PER WOODLAND RESTORATION PLAN PAGE 4 OF 5.
- STRIP NON-WOODLAND TOPSOIL AND OVERBURDEN SEPARATELY AND USE THE MATERIALS TO CONSTRUCT ACUSTICAL BERMS TO RECOMMENDED SPECIFICATIONS FOR PHASE A. EXCESS OVERBURDEN AND TOPSOIL MAY BE STORED IN PILES ON THE PIT FLOOR OR STORAGE BERM AS SHOWN.
- BEGIN EXTRACTION OF AREA 1 IN DIRECTION SHOWN. STOCKPILING AREA MAY BE TEMPORARILY LOCATED NEAR THE PIT FACE DURING THE INITIAL EXTRACTION OF AGGREGATE.
- THE WOODLAND RESTORATION PLAN PHASES FIGURE IN THE SECTIONS AND DETAILS PLAN (PAGE 4 OF 5) PROVIDES THE PHASING OF EXTRACTIONS WITHIN THE TREAED RIDGE.
- UNDISTURBED PORTIONS OF AREAS 1 AND 2 REMAIN IN AGRICULTURAL USE.
- DURING PHASE 1 OPERATIONS, PLANT A TREE SCREEN CONSISTING OF NATIVE CONIFEROUS TREE SPECIES, STAGGERED IN TWO ROWS ALONG THE SOUTHEAST BOUNDARY AND ALONG 31ST LINE AS SHOWN.
- BEGIN INVASIVE AND NON-NATIVE SPECIES CONTROL IN WOODLAND RESTORATION AREA 2 PER WOODLAND RESTORATION PLAN PAGE 4 OF 5.
- MAINTAIN ALL VEGETATION IN A HEALTHY, VIGOROUS GROWING CONDITION

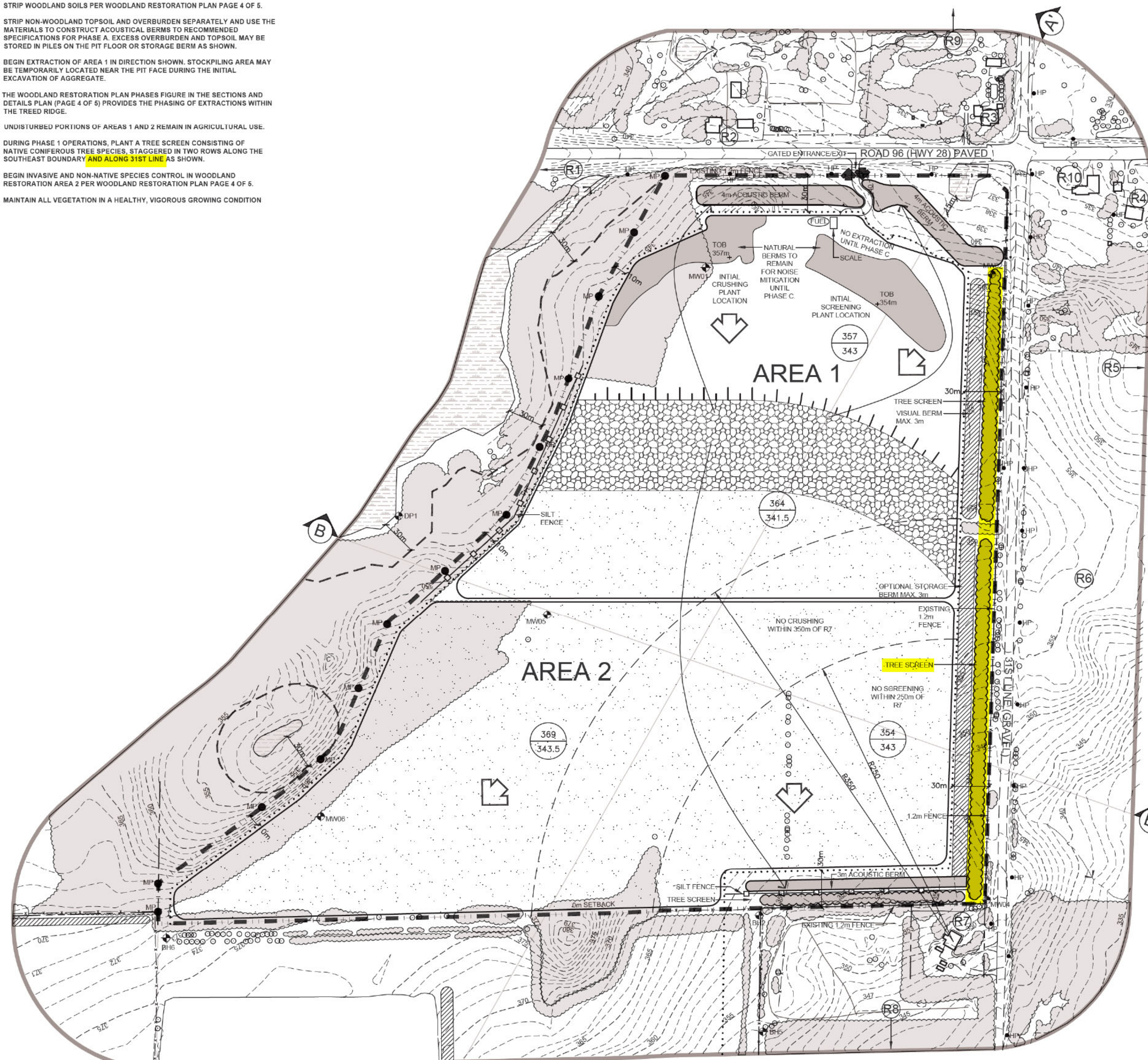

**OPERATIONS NOTES**

- GENERAL INFORMATION**
- THIS PLAN DEPICTS A SCHEMATIC OPERATIONS AND REHABILITATION SEQUENCE FOR THIS PROPERTY BASED ON THE BEST INFORMATION AVAILABLE AT THE TIME OF PREPARATION. PHASES SHOWN ARE SCHEMATIC AND WILL BE OPERATED ACCORDING TO MATERIAL QUALITY, SITE HYDROLOGY AND HYDROGEOLOGY OR MARKET DEMAND.
  - EXTRACTION AND PROGRESSIVE REHABILITATION SHALL FOLLOW THE SEQUENCE SHOWN. DEMAND FOR CERTAIN PRODUCTS OR BLENDING OF MATERIALS MAY REQUIRE SOME DEVIATION IN THE EXTRACTION AND REHABILITATION PHASING. ANY DEVIATIONS FROM THE OPERATIONS SEQUENCE SHOWN WILL REQUIRE APPROVAL FROM MNR.
  - SITE PLAN VARIANCES ARE LISTED IN THE SITE PLAN VARIANCE TABLE SHOWN ON THIS PAGE.
- EXTRACTION/PROCESSING/HAULING INFORMATION**
- TOTAL AREA TO BE EXTRACTED IS 23.6 HECTARES.
  - a) MAXIMUM NUMBER OF TONNES OF AGGREGATE TO BE REMOVED FROM THE SITE IN ANY CALENDAR YEAR IS 500,000 TONNES.
  - b) EXTRACTION OF SAND AND GRAVEL ABOVE WATER TABLE WILL TAKE PLACE IN 3 BENCHES, WITH A MAXIMUM HEIGHT OF 8 METRES AND WILL COMPLY WITH OHSR REGULATIONS REGARDING FACE HEIGHTS. THE GROUNDWATER TABLE IS ESTIMATED TO BE BETWEEN 338.70 TO 343.3m ASL. FRONT END LOADERS WILL BE USED TO EXTRACT MATERIAL AND HAUL TRUCKS OR CONVEYORS WILL CARRY MATERIAL VIA HAUL ROADS TO THE PLANT FOR FURTHER PROCESSING. HAUL ROADS SHALL BE CONSTRUCTED AS REQUIRED. REFER TO SECTIONS A AND B ON DRAWING 4 OF 5 FOR FURTHER DETAILS.
  - c) PORTABLE PROCESSING EQUIPMENT FOR CRUSHING AND SCREENING WILL BE USED ON SITE AND WILL BE LOCATED ON THE PIT FLOOR CLOSE TO THE PIT FACE AT START UP. IN ADDITION TO PROCESSING, SITE ACTIVITIES WILL INCLUDE STRIPPING AND REHABILITATION. OPERATIONAL EQUIPMENT MAY INCLUDE TRUCKS, LOADERS, EXCAVATOR, BACKHOES, BULLDOZERS, SCRAPERS, CONVEYORS, WASH PLANTS, AND OTHER RELATED EQUIPMENT. PROCESSING EQUIPMENT, STACKS AND PRODUCT STOCKPILES WILL NOT EXCEED 15 METRES IN HEIGHT AND WILL BE LOCATED IN THE AREAS SHOWN AND/OR CLOSE TO PIT FACES. HAUL ROADS SHALL BE LOCATED AS REQUIRED.
  - d) A SCALE AND SCA HOUSE AND TEMPORARY STORAGE/OFFICE TRAILERS MAY BE LOCATED ON SITE, 30m FROM THE LICENCE BOUNDARY.
  - e) MATERIAL FROM OTHER PROPERTIES MAY BE IMPORTED INTO THE SITE FOR BLENDING, CUSTOM PRODUCTS AND/OR RESALE. THIS MAY INCLUDE AGGREGATE AND/OR PEAT AND TOPSOIL (IN AREA 2). i) EXCESS SOIL SHALL ONLY BE IMPORTED FOR BLENDING, RESALE AND/OR TEMPORARY STORAGE ON-SITE IN ACCORDANCE WITH ONTARIO REGULATION 244/97 UNDER THE AGGREGATE RESOURCES ACT. ii) LIQUID SOIL, AS DEFINED IN ONTARIO REGULATION 406/19 UNDER THE ENVIRONMENTAL PROTECTION ACT, IS NOT AUTHORIZED FOR IMPORTATION TO THE SITE. iii) THERE SHALL BE NO FURTHER IMPORTATION OF EXCESS SOIL FOR BLENDING, RESALE, AND/OR TEMPORARY STORAGE ONCE EXTRACTION ON-SITE HAS BEEN COMPLETED. iv) THE TOTAL AMOUNT OF EXCESS SOIL BROUGHT ONTO THE SITE ANNUALLY AND THE TOTAL AMOUNT STORED ON-SITE AT ANY ONE TIME WILL NOT EXCEED 25,000 M3.
  5. EQUIPMENT AND MACHINERY ASSOCIATED WITH THE EXTRACTION OPERATIONS WILL BE REMOVED UPON COMPLETION OF EXTRACTION.
- HYDROGEOLOGICAL INFORMATION**
6. THE WATER TABLE ELEVATION VARIES ACROSS THIS LICENCE FROM APPROXIMATELY 338.70 TO 343.3 m ABOVE SEA LEVEL (A.S.L.), BASED ON THE HYDROGEOLOGICAL REPORT (SEE ABOVE). REFER TO SECTIONS ON SHEET 4 OF 5.
  7. SURFACE DRAINAGE WILL BE DIRECTED TO LOW AREAS FOR WATER TO INFILTRATE INTO THE GRANULAR MATERIALS ON THE PIT FLOOR. THERE WILL BE NO OFF-SITE DITCHING/DISCHARGE.
- NOISE MITIGATION INFORMATION**
8. HOURS OF OPERATION:  
SITE PREPARATION AND REHABILITATION: 07:00-19:00 WEEKDAYS, 08:00 - NOON SATURDAYS  
EXCAVATION AND PROCESSING: 07:00-19:00 WEEKDAYS, 08:00 - NOON SATURDAYS  
SHIPPING: 07:00-19:00 WEEKDAYS, 08:00 - NOON SATURDAYS  
NO OPERATIONS SHALL OCCUR ON STATUTORY HOLIDAYS AND SUNDAYS.
- AIR QUALITY INFORMATION**
9. WATER OR CALCIUM CHLORIDE WILL BE APPLIED TO INTERNAL HAUL ROADS AND PROCESSING AREAS AS OFTEN AS REQUIRED TO MITIGATE DUST.
- SITE MANAGEMENT INFORMATION**
- MAINTENANCE/PROTECTION OF VEGETATION INFORMATION**
10. EXISTING VEGETATION WITHIN THE LICENCED AREA SHALL BE MAINTAINED IN A HEALTHY VIGOROUS GROWING CONDITION UNTIL SEQUENTIAL STRIPPING BEGINS OR UNTIL THE REHABILITATION IS COMPLETE. ANY VEGETATION PLANTED AS PART OF SITE IMPROVEMENTS OR FINAL REHABILITATION WILL ALSO BE MAINTAINED IN A HEALTHY, VIGOROUS GROWING CONDITION.
- FENCING INFORMATION**
11. BOUNDARIES OF THE AREA TO BE LICENCED THAT ARE PRESENTLY FENCED ARE SHOWN ON DRAWING 1 OF 5 EXISTING FEATURES. PRIOR TO ANY STRIPPING OR PREPARATION, FENCING ON THE LICENCED BOUNDARIES WILL BE UPGRADED TO 1.2m HIGH WIRE TO COMPLY WITH THE AGGREGATE RESOURCES ACT WHERE REQUIRED. UNFENCED BOUNDARIES SHALL BE DEMARCATED WITH HIGHLY VISIBLE MARKER POSTS AT INTERVISIBLE INTERVALS.
- TOPSOIL/SUBSOIL/OVERBURDEN STORAGE INFORMATION**
12. TOPSOIL AND OVERBURDEN SHALL BE STRIPPED AND STORED SEPARATELY IN BERMS WHERE SHOWN AND ON THE PIT FLOOR.
  13. STRIP AND STORE FOREST SOILS PER WOODLAND RESTORATION PLAN (PAGE 4 OF 5).
- BERM INFORMATION**
14. BERMS SHALL BE CONSTRUCTED AS SPECIFIED IN THE HGC NOISE ASSESSMENT REPORT DATED JANUARY 2024 AND SHOWN ON OPS PLAN. BERMS SHALL NOT EXCEED 2.1. REFER TO TYPICAL BERM CROSS SECTION ON DRAWING 3 OF 5. ALL BERMS SHALL BE SEEDED USING GRASS/LEGUME MIXTURE, SEE REHABILITATION PLAN (NOTE #7) IMMEDIATELY UPON COMPLETION TO MINIMIZE NOISE, DUST AND EROSION. ALL BERMS SHALL BE MAINTAINED.
  15. ON COMPLETION OF THE BERMS, EXCESS ON-SITE OVERBURDEN WILL BE USED TO PROGRESSIVELY BACKFILL AND REHABILITATE THE SITE. TOPSOIL CAN BE TEMPORARILY STOCKPILED ON THE PIT FLOOR.
- SCRAP STORAGE INFORMATION**
16. ALL SCRAP/USED MACHINERY GENERATED THROUGH THE OPERATIONS WITHIN THIS LICENCE WILL BE REMOVED FROM THE SITE AND DISPOSED OF ON AN ONGOING BASIS.
- TREE/STUMP REMOVAL**
17. STUMPS/ WOODY MATERIAL MAY BE CHIPPED AND USED FOR SOIL ENHANCEMENT DURING PROGRESSIVE REHABILITATION. TREES WILL BE HARVESTED AND SOLD AS LUMBER OR UTILIZED FOR FIREWOOD AND/OR THEIR BEST USE.
- PETROLEUM STORAGE INFORMATION**
18. FUEL, OIL, RADIATOR AND HYDRAULIC FLUID, AND OTHER CHEMICALS NEEDED FOR THE MAINTENANCE AND FUNCTIONING OF ON-SITE AGGREGATE PROCESSING EQUIPMENT SHALL BE APPROPRIATELY STORED IN ABOVE-GROUND CONTAINERS AT THE SCALEHOUSE AND SHALL MEET THE REQUIREMENTS OF THE TECHNICAL STANDARDS AND SAFETY ACT (TSSA) AND LIQUID FUELS HANDLING CODE, AND IN ACCORDANCE WITH THE MINISTRY OF THE ENVIRONMENT, CONSERVATION, AND PARKS CHEMICAL STORAGE GUIDELINES. ALL REFUELLING SHALL BE WITHIN A CONTAINMENT PAD. ALL SPILLS TO THE ENVIRONMENT MUST BE REPORTED TO THE SPILLS ACTION CENTRE OF MECP. ANY SPILL SHALL BE REMOVED AND DISPOSED OF AT AN APPROPRIATE MECP APPROVED FACILITY.

**SITE PLAN VARIANCES**

THE FOLLOWING CONDITIONS ILLUSTRATED ON THESE PLANS VARY FROM THE OF THE PROVINCIAL STANDARDS MADE UNDER THE AGGREGATE RESOURCES ACT

ITEM	STANDARD
1. SETBACK IS REDUCED TO 0m ALONG THE SOUTH BOUNDARY PER AGREEMENT WITH ADJACENT LICENCE No. 602642.  SETBACK IS REDUCED TO 0m ALONG WEST BOUNDARY, ADJACENT LAND IS OWNED BY LICENSEE.	0.13(1)10
2. STOCKPILING MAY OCCUR WITHIN 30m OF THE WEST BOUNDARY, ADJACENT LANDS OWNED BY LICENSEE AND THE SOUTH BOUNDARY ADJACENT LICENCE 602642 PER AGREEMENT WITH ADJACENT LICENSEE.	0.13(1)13
3. FENCING WILL BE OMITTED FROM THE WEST BOUNDARY, ADJACENT LAND IS OWNED BY LICENSEE AND THERE IS NO ACCESS DUE TO STEEP TOPOGRAPHY, FOREST, AND WETLANDS.  FENCING SHALL NOT BE MAINTAINED ALONG THE SOUTH BOUNDARY ADJACENT LICENCE 602642 PER AGREEMENT WITH ADJACENT LICENSEE.	0.13(3)a

**LEGEND**

- 120m INFORMATION BOUNDARY
- BOUNDARY OF PROPOSED LICENCE
- BOUNDARY OF EXISTING LICENCE
- REGULATORY SETBACK AND NATURAL ENVIRONMENT EXTRACTION LIMIT LINE
- PROPERTY LINE
- EXISTING FENCE
- EXISTING 6m CONTOUR LINE
- EXISTING 1m CONTOUR LINE
- EXISTING SPOT ELEVATION
- LOCATION OF CROSS SECTION
- EXISTING VEGETATION
- EXISTING WETLAND
- EXTRACTION FACE
- ACUSTICAL BERM/BARRIER
- STORAGE BERM
- UNDISTURBED AREA
- AREA STRIPPED OF TOPSOIL AND OVERBURDEN
- SILT FENCE
- PROPOSED MARKER POST
- EXISTING BUILDING
- BH1 MW1 BOREHOLE/MONITORING WELL, INSTALLED ENGBLOE AUGUST 16-18, 2022 & JANUARY 22, 2023
- HP HYDRO POLE
- SMALL STREAM, AGRICULTURAL DITCH/SWALE
- GATED ENTRANCE/EXIT
- DIRECTION OF EXTRACTION
- DIRECTION OF TOPSOIL AND OVERBURDEN MOVEMENT
- R03 LOCATION OF NOISE RECEPTOR
- EXISTING ELEVATION
- PROPOSED ELEVATION

NO.	DATE	REVISIONS	OFFICER	FM	MNR	NO.	DATE	REVISIONS	OFFICER	FM	MNR
5.	MAY 2026	PER COUNTY COMMENTS									
4.	JAN 2026	PER COMMENTS									
3.	NOV 2025	PER MNR COMMENTS									
2.	SEPT 2025	PER MNR COMMENTS									
1.	JULY 2025	PER COMMENTS									

Pre Licence Review      Site Plan Amendments

**Harrington Ontario Inc.**  
41 Main Street, Unit 102  
Unionville, Ontario L3R 2E5  
Tel: 905-294-8282 Fax: 905-294-7523  
www.harringtonmcavan.com

**Project Name**  
**1000394952**  
**ONTARIO INC.**  
**HARRINGTON PIT**  
LICENCE No. 626649  
SIGNATURE OF LICENSEE *Amir Schellm*  
PART LOT 30, CONSESSION 1  
TOWNSHIP OF ZORRA (FORMERLY WEST ZORRA),  
COUNTY OF OXFORD

Scale 1:2000      North      Stamp  
Drawing Status      SUBMITTED FOR APPROVAL      ASSOCIATION OF LANDSCAPE ARCHITECTS OF ONTARIO MEMBER

Drawn SB      Checked RM/BJ      Issue Date MAY 2026  
Drawing Title      Project Number 22-15      Drawing Number 2 OF 5  
**OPERATIONAL PLAN PHASE A**

### LEGEND

	120m INFORMATION BOUNDARY
	BOUNDARY OF PROPOSED LICENCE
	BOUNDARY OF EXISTING LICENCE
	REGULATORY SETBACK AND NATURAL ENVIRONMENT EXTRACTION LIMIT LINE
	PROPERTY LINE
	EXISTING FENCE
	LOCATION OF CROSS SECTION
	EXISTING VEGETATION
	EXISTING WETLAND
	PROGRESSIVE REHABILITATION
	REHABILITATED AREA
	ACOUSTIC BERM
	STORAGE BERM
	UNDISTURBED AREA
	AREA STRIPPED OF TOPSOIL AND OVERBURDEN
	SILT FENCE
	PROPOSED MARKER POST
	EXISTING BUILDING
	BOREHOLE MONITORING WELL INSTALLED ENGLAGE AUGUST 16-18, 2022 & JANUARY 22, 2023
	HYDRO POLE
	SMALL STREAM, AGRICULTURAL DITCH/SWALE
	ENTRANCE/EXIT
	DIRECTION OF EXTRACTION
	DIRECTION OF TOPSOIL AND OVERBURDEN MOVEMENT
	R03 LOCATION OF NOISE RECEPTOR
	EXISTING ELEVATION
	PROPOSED ELEVATION



6. MAY 2026	PER COUNTY COMMENTS			
4. JAN 2026	PER COMMENTS			
3. NOV 2025	PER MNR COMMENTS			
2. SEPT 2025	PER MNR COMMENTS			
1. JULY 2025	PER COMMENTS			

**Harrington McAvan Ltd**  
 41 Main Street, Unit 102  
 Unionville, Ontario L3R 2E5  
 Tel: 905-294-8282 Fax: 905-294-7623  
 www.harringtonmcavan.com

Project Name  
**1000394952**  
**ONTARIO INC.**  
**HARRINGTON PIT**  
 LICENCE No. 626649  
 SIGNATURE OF LICENSEE *Amos Schelm*  
 PART LOT 30, CONCESSION 1  
 TOWNSHIP OF ZORRA (FORMERLY WEST ZORRA),  
 COUNTY OF OXFORD

Scale 1:4000  
 North  
 Drawing Status  
 SUBMITTED FOR APPROVAL  
 Drawn SB  
 Checked RM/BJ  
 Issue Date MAY 2026

Drawing Title  
**OPERATIONAL PLAN PHASE B-D**  
 Project Number  
**22-15**  
 Drawing Number  
**3 OF 5**

FILE NAME: 22-15/COMP/2215-3.DWG  
 PLOT DATE: MAY 6, 2026

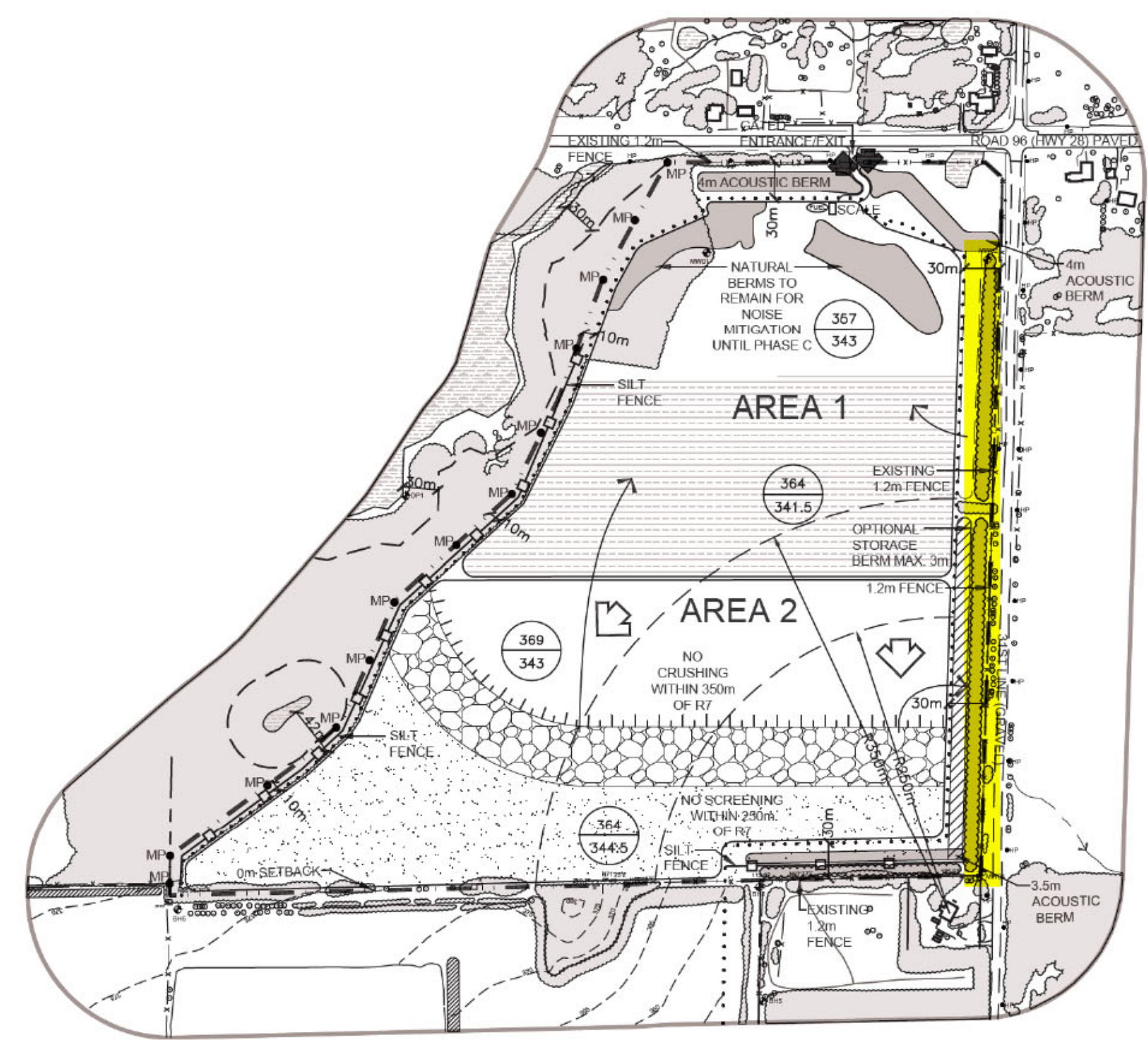

- ### PHASE B PHASE B NOTES
- BEGIN PROGRESSIVE REHABILITATION OF SOUTH PART OF AREA 1 USING MATERIAL STORED IN BERMS. 50% OF AREA 1 SHALL BE REHABILITATED PRIOR TO EXTRACTION IN AREA 2.
  - AFTER WEST SIDE SLOPE IS CONSTRUCTED, BEGIN WOODLAND RESTORATION USING WOODLAND SOILS STORED ON SITE PER WOODLAND RESTORATION PLAN PAGE 4 OF 5.
  - PRIOR TO EXTRACTION IN AREA 2, STRIP WOODLAND SOILS PER WOODLAND RESTORATION PLAN PAGE 4 OF 5.
  - STRIP NON-WOODLAND TOPSOIL AND OVERBURDEN SEPARATELY AND USE MATERIAL TO CONSTRUCT ACOUSTICAL BERM TO RECOMMENDED SPECIFICATIONS FOR PHASE B. EXCESS MATERIAL MAY BE STORED IN STORAGE BERMS AS SHOWN AND STOCKPILED ON PIT FLOOR.
  - COMPLETE REHABILITATION OF 50% OF AREA 1.
  - BEGIN EXTRACTION OF AREA 2 IN DIRECTION SHOWN. STOCKPILING AREA MAY BE TEMPORARILY LOCATED NEAR THE PIT FACE DURING THE INITIAL EXCAVATION OF AGGREGATE.
  - UNDISTURBED PORTION OF AREA 2 REMAINS IN AGRICULTURAL USE.
  - MAINTAIN ALL VEGETATION IN A HEALTHY, VIGOROUS GROWING CONDITION

### TECHNICAL RECOMMENDATIONS

- THE FOLLOWING ARE THE TECHNICAL RECOMMENDATIONS FROM ALL OF THE EXPERTS' REPORTS AS OF NOVEMBER 2023. ADDITIONAL RECOMMENDATIONS MAY BE INCLUDED AS A RESULT OF THE LICENCE REVIEW PROCESS.
- ACOUSTIC REPORT BY HCC ENGINEERING, DATED JULY 2024, REVISED APRIL 2025, REVISED JUNE 16, 2025, REVISED JULY 11, 2026**
- THE TABLE BELOW PRESENTS THE ENERGY AVERAGED REFERENCE SOUND LEVELS USED FOR THE ACOUSTIC MODELING PRESENTED HEREIN. THESE WERE BASED ON SITE MEASUREMENTS OF PROCESSING EQUIPMENT TO BE USED IN THIS PIT WHICH IS CURRENTLY IN USE AT ANOTHER WILHELM EXCAVATING LIMITED LOCATION AND ADDITIONAL INFORMATION TAKEN FROM OUR FILES FOR OTHER SIMILAR FACILITIES.
- | EQUIPMENT                                                   | SOUND POWER LEVEL | SOUND PRESSURE LEVEL |
|-------------------------------------------------------------|-------------------|----------------------|
| CRUSHING & SCREENING PLANT AND ASSOCIATED LOADER (COMBINED) | 119 dBA           | 77 dBA AT 50m        |
| SCREENING PLANT & ASSOCIATED LOADER (COMBINED)              | 113 dBA           | 71 dBA AT 50m        |
| LOADER OR EXCAVATOR                                         | 108 dBA           | 66 dBA AT 50m        |
- IF OTHER EQUIPMENT IS PROPOSED FOR OPERATION IN THE GRAVEL PIT, IT SHALL BE CONFIRMED THROUGH MEASUREMENT TO PRODUCE SOUND LEVELS CONSISTENT WITH THE ABOVE REFERENCED SOUND LEVELS OR ADDITIONAL MITIGATION MEASURES MAY BE REQUIRED.
- PRIOR TO EXTRACTION AND PROCESSING ACTIVITIES IN AREA 1, A 4 m HIGH NOISE BARRIER ABOVE EXISTING GRADE SHALL BE CONSTRUCTED ALONG THE NORTHERN BOUNDARY AND NORTHEAST CORNER OF AREA 1.
  - THE PROCESSING (CRUSHING) PLANT SHALL INITIALLY BE LOCATED AT THE NORTHWEST PART OF AREA 1 IN A PREVIOUSLY EXTRACTED AREA AT THE FINAL PIT FLOOR ELEVATION AS INDICATED IN THE OPERATIONAL PLAN, WITHIN 40 m OF THE FORMER PIT FACE (MINIMUM TOP OF ELEVATION OF 357 MSL). THE CRUSHING PLANT SHALL REMAIN ON THE FINAL PIT FLOOR ELEVATION FOR THE ENTIRE PIT OPERATIONS.
  - THE PROCESSING (SCREENING) PLANT SHALL INITIALLY BE LOCATED AT THE NORTHEAST PART OF AREA 1 ON THE SOUTH SIDE OF THE NATURAL BERM WITH A TOP ELEVATION OF 354 MSL AS INDICATED IN THE OPERATIONAL PLAN AT FINAL PIT FLOOR ELEVATION.
  - THE INITIAL EXCAVATION TO LOCATE THE PROCESSING (CRUSHING AND SCREENING) EQUIPMENT ON THE FINAL PIT FLOOR SHALL BE A "LOAD AND HAUL" OPERATION AS SHALL THE FINAL EXCAVATION OF THE REMAINING MATERIAL AT THE NORTH OF THE SITE IN THE PHASE 1 AREA.
  - WHEN THE PROCESSING (CRUSHING) PLANT IS MOVED SOUTH OF THE INITIAL LOCATION AND OPERATING IN AREA 1, A MINIMUM 7 m HIGH ACOUSTICAL BARRIER SHALL BE CONSTRUCTED BESIDE THE CRUSHING PLANT IN THE DIRECTION OF R2 TO R8, R9 AND R10.
  - PRIOR TO EXTRACTION AND PROCESSING ACTIVITIES IN AREA 2, A 3 m HIGH NOISE BARRIER ABOVE EXISTING GRADE SHALL BE CONSTRUCTED ALONG THE EASTERN PORTION OF THE SOUTHERN BOUNDARY.

- THE CRUSHING PLANT SHALL NOT OPERATE WITHIN 350 m OF R7.
  - THE SCREENING PLANT SHALL NOT OPERATE WITHIN 250 m OF R7.
  - WHEN THE CRUSHING PLANT IS OPERATING IN AREA 2, A MINIMUM 7 m HIGH ACOUSTICAL BARRIER SHALL BE CONSTRUCTED BESIDE THE CRUSHING PLANT IN THE DIRECTION OF R5 TO R8.
  - WHEN THE SCREENING PLANT IS OPERATING IN AREA 2, MINIMUM 7 m HIGH ACOUSTICAL BARRIER SHALL BE CONSTRUCTED BESIDE THE SCREENING PLANT IN THE DIRECTION OF R5 TO R8.
  - ACTIVITIES USED TO PREPARE THE SITE FOR EXCAVATION, SUCH AS THE STRIPPING OF TOPSOIL, CONSTRUCTION OF BERMS, LOCATING THE PROCESSING PLANTS AT THEIR INITIAL LOCATIONS ON THE PIT FLOOR ELEVATION, OR ACTIVITIES RELATED TO THE REMEDIATION OF THE SITE AFTER THE EXTRACTION IS COMPLETED ARE CONSIDERED TO BE CONSTRUCTION ACTIVITIES. THEY ARE REGULATED UNDER MUNICIPAL BYLAWS AND MPC-115 "SOUND LEVEL LIMITS FOR MOTORIZED CONSTRUCTION EQUIPMENT".
  - LOADERS AND EXCAVATORS OPERATING IN THE PIT SHALL BE PROVIDED WITH "BACK-UP" WARNING DEVICES WHICH UTILIZE "WHITE NOISE" RATHER THAN A "BEEPING SOUND" SUBJECT TO APPLICABLE HEALTH AND SAFETY GUIDELINES.
  - TRUCKING ACTIVITIES SHALL BE ORGANIZED TO AS MUCH AS POSSIBLE NOT REQUIRE THE USE OF REVERSE GEAR.
  - THE ACOUSTICAL BARRIERS REFERRED TO IN RECOMMENDATIONS 6, 10 AND 11 CAN TAKE THE FORM OF STOCKPILES OF PROCESSED MATERIAL MAINTAINED TO PROVIDE CONTINUOUS SHIELDS OF THE PROCESSING EQUIPMENT IN THE DIRECTION OF THE IDENTIFIED RECEPTORS AS THE EQUIPMENT MOVES THROUGH SOUTH.
  - ANY PROPOSED CHANGES TO THE ASPECTS OF THE EXTRACTION, PROCESSING AND SHIPPING OPERATIONS DEALT WITH ABOVE RELATING TO NOISE CONTROL SHALL BE REVIEWED BY A QUALIFIED ACOUSTICAL CONSULTANT FOR COMPLIANCE WITH THE RELEVANT NOISE CRITERIA. AN AMENDMENT MAY BE REQUIRED TO IMPLEMENT ANY NOISE CONTROL CHANGES (E.G. EQUIPMENT, MITIGATION MEASURES, ETC.).
- HYDROLOGICAL REPORT BY GROUNDWATER SCIENCE CORP., DATED JUNE 2024, UPDATED PER COMMENTS JUNE 2025**
- IN ORDER TO CONFIRM WATER TABLE ELEVATIONS AT THE SITE, THE FOLLOWING MONITORING PROGRAM IS RECOMMENDED FOR A PERIOD OF 3 YEARS:
- FOR A PERIOD OF 3 YEARS WATER LEVEL MEASUREMENTS SHALL BE OBTAINED ON A QUARTERLY (SEASONAL) BASIS AT MW01, MW02, MW04, MW05, MW09, AND DPT1, AS ACCESSIBLE.
  - THE MONITORING RESULTS WILL BE SUMMARIZED ANNUALLY BY THE OPERATOR AND MADE AVAILABLE TO MNR UPON REQUEST.
  - MONITORS MW05 AND MW06 SHALL BE DECOMMISSIONED BY A LICENSED WATER WELL CONTRACTOR ACCORDING TO ALL APPLICABLE REGULATIONS PRIOR TO EXTRACTION IN AREA 2.

- NATURAL ENVIRONMENT REPORT BY DANCE ENVIRONMENTAL, DATED JULY 2024**
- PRIOR TO TOPSOIL REMOVAL, HEAVY DUTY SILT FENCE SHALL BE PLACED ON THE EASTERN SIDE OF THE WESTERN LICENCE BOUNDARY, AND HEAVY-DUTY SILT FENCE SHALL ALSO BE PLACED ALONG THE SOUTHERN EDGE OF THE PROPERTY IN THE SOUTHEASTERN CORNER OF THE PIT PRIOR TO TOPSOIL REMOVAL IN AREA 2.
  - THE SILT FENCE SHALL BE INSPECTED AT WEEKLY INTERVALS AND FOLLOWING ANY PRECIPITATION EVENT ≥ 2.5 cm AND SHALL BE REPAIRED IMMEDIATELY, UNTIL SUCH TIME AS THE GROUND COVER VEGETATION IS ESTABLISHED.
  - THE LIMITS OF EXTRACTION SHALL BE DEMARCATED, TO PREVENT EQUIPMENT FROM IMPACTING THE SIGNIFICANT NATURAL FEATURES.
  - CLEARING OF ANY VEGETATION WITHIN THE LIMIT OF EXTRACTION SHALL OCCUR BETWEEN OCTOBER 1 AND MARCH 31.
  - THE WESTERN SETBACK SHALL BE LEFT UNDISTURBED TO NATURALIZE.
  - EFFECTIVE DUST CONTROL SHALL BE MAINTAINED ALONG THE ACCESS ROAD IN THE PIT SO THAT DUST DOES NOT IMPACT ADJACENT VEGETATION AND WILDLIFE.
  - EQUIPMENT FUELING, MAINTENANCE AND FUEL STORAGE SHALL BE LOCATED ON THE PORTION OF THE SITE RECOMMENDED BY THE HYDROLOGICIST, AWAY FROM THE NATURAL FEATURES.
  - THE FOLLOWING ECOLOGICAL ENHANCEMENT/RESTORATION INSTALLATIONS SHALL BE MADE WHEN SITE MARGIN REHABILITATION IS UNDERTAKEN:
    - ALONG THE WESTERN SLOPE OF THE PIT, 3 EASTERN BLUEBIRD/TREE SWALLOW NEST BOXES, A TOTAL OF 20 BAT HOUSES (BAT CONSERVATION INTERNATIONAL OR MERLIN TUTTLE CERTIFIED DESIGN, AS PER THE RESTORATION AND REHABILITATION PLAN (NOVEMBER 2025), 3 STONE PILES, AND TREES, SHRUBS AND POLLINATOR SEED MIX WILL BE ESTABLISHED PER THE RESTORATION AND REHABILITATION PLAN (NOVEMBER 2025).
    - ALONG THE PIT FLOOR IN THE SOUTHERN AREA OF THE ZERO METRE SETBACK, 3 EASTERN BLUEBIRD/TREE SWALLOW NEST BOXES AND 3 BAT CONSERVATION INTERNATIONAL OR MERLIN TUTTLE CERTIFIED DESIGN BAT BOXES, AND NODULES OF NATIVE WILDLIFE SHRUBS AND TREES AND POLLINATOR - BENEFICIAL HERBS SHALL BE INSTALLED.
  - AT THE SAME TIME AS THE WOODLAND RESTORATION MONITORING OCCURS, THE BAT BOXES SHALL BE CHECKED TO ENSURE THE STRUCTURES ARE STILL STANDING, AND FOR ANY SIGNS OF USE BY BATS. IF THE BAT BOXES ARE DAMAGED OR ANY ISSUES WITH THE POSTS ON WHICH THEY ARE PLACED ARE FOUND, RECOMMISSIONING TO THE PIT OPERATOR SHALL BE MADE ON HOW TO REPAIR THE ISSUE.
  - ECOLOGICAL MONITORING:
    - AMPHIBIAN MONITORING SHALL BE UNDERTAKEN AS FOLLOWS: TWO YEARS OF BASELINE MONITORING SHALL COMMENCE WHEN EXTRACTION IS WITHIN 60 m OF THE WESTERN LICENCE BOUNDARY. ANNUAL MONITORING SHALL OCCUR FOR 8 YEARS AND THEN, THE NEED FOR CONTINUED MONITORING SHALL BE REVIEWED.
    - BASELINE MONITORING FOR AMPHIBIANS SHALL BE UNDERTAKEN DURING THE OPERATIONS TO DOCUMENT IF THERE IS A DETECTABLE DECLINE IN WOODLAND AMPHIBIAN BREEDING. IF BREEDING HAS DECLINED, ONCE RESTORATION OF THE WOODLAND HAS BEEN COMPLETED, MONITORING SHALL CONTINUE, TO DETERMINE IF BREEDING LEVELS HAVE INCREASED. IF BREEDING CONTINUES AT THE SAME LEVELS THROUGHOUT THE OPERATION, MONITORING AT THE END OF THE REFORESTATION IS NOT RECOMMENDED. MONITORING SHALL USE THE SAME PROTOCOL (MMP) THAT

- WAS USED FOR AMPHIBIAN SURVEYS IN THE DEVELOPMENT OF THE NER.
- FROG AND TOAD CHORUS MONITORING SHALL OCCUR AT 2 OR 3 STATIONS USING THE MARSH MONITORING PROTOCOL. MEWT NUMBERS SHALL BE ESTIMATED IN SPRING FROM THE POND EDGES USING BINOCULARS.
  - AN ANNUAL MONITORING REPORT ON AMPHIBIAN POPULATIONS SHALL BE SUBMITTED TO MNR BY MARCH 31ST OF THE FOLLOWING YEAR.
  - BASELINE MONITORING SHALL BE UNDERTAKEN DURING THE OPERATIONS TO DOCUMENT IF THE WOOD THRUSH AND WOOD PEWEE BREEDING LEVELS HAVE BEEN REDUCED OR ELIMINATED. IF BREEDING HAS BEEN REDUCED, ONCE RESTORATION OF THE WOODLAND HAS BEEN COMPLETED, A FINAL ROUND OF MONITORING SHALL BE UNDERTAKEN. IF BREEDING CONTINUES THROUGHOUT THE OPERATION, MONITORING AT THE END OF THE RESTORATION IS NOT RECOMMENDED. MONITORING SHALL USE THE SAME OBBA PROTOCOL AS WAS FOLLOWED DURING BREEDING BIRD SURVEYS DURING DEVELOPMENT OF THE NER, WITH REPORTS SUBMITTED TO MNR.
- ARCHAEOLOGICAL ASSESSMENT BY ARCHAEOLOGICAL RESEARCH ASSOCIATES LTD, DATED AUGUST 2023**
- SHOULD PREVIOUSLY UNDOCUMENTED ARCHAEOLOGICAL RESOURCES BE DISCOVERED, THEY MAY BE A NEW ARCHAEOLOGICAL SITE AND THEREFORE SUBJECT TO SECTION 48 (1) OF THE ONTARIO HERITAGE ACT. THE PROPONENT OR PERSON DISCOVERING THE ARCHAEOLOGICAL RESOURCES MUST CEASE ALTERATION OF THE SITE IMMEDIATELY AND ENGAGE A LICENSED CONSULTANT ARCHAEOLOGIST TO CARRY OUT ARCHAEOLOGICAL FIELDWORK, IN COMPLIANCE WITH SECTION 48 (1) OF THE ONTARIO HERITAGE ACT.

- ### PHASE C PHASE C NOTES
- BEGIN REHABILITATION OF AREA 2 USING MATERIAL IN STORAGE BERM OR STOCKPILED ON PIT FLOOR, AS RESOURCES ARE DEPLETED.
  - AFTER WEST SIDE SLOPE IS CONSTRUCTED, CONTINUE WOODLAND RESTORATION USING WOODLAND SOILS STORED ON SITE PER WOODLAND RESTORATION PLAN PAGE 4 OF 5.
  - COMPLETE EXTRACTION OF AREA 2.
  - STRIP REMAINING WOODLAND TOPSOIL AND OVERBURDEN AND STORE PER WOODLAND RESTORATION PLAN PAGE 4 OF 5.
  - CONTINUE EXTRACTION OF AREA 1 IN DIRECTION SHOWN.
  - MAINTAIN ALL VEGETATION IN A HEALTHY, VIGOROUS GROWING CONDITION.

- ### PHASE D NOT SHOWN PHASE D NOTES
- COMPLETE EXTRACTION OF AREA 1 AND BEGIN REHABILITATION OF REMAINING AREA.
  - AFTER WEST SIDE SLOPE IS CONSTRUCTED, CONTINUE WOODLAND RESTORATION USING WOODLAND SOILS STORED ON SITE PER WOODLAND RESTORATION PLAN PAGE 4 OF 5.
  - REMOVE ALL SCRAP AND EQUIPMENT.
  - COMPLETE REHABILITATION OF ALL REMAINING AREAS INCLUDING INTERNAL HAUL ROADS USING MATERIAL STORED IN BERMS.
  - REHABILITATION WILL BE TO NATURAL AREAS AND AGRICULTURE.